

According to law Danieli&C. considers this document to be a company secret and therefore prohibits any person to reproduce it or make it known in whole or in part to other parties or to competitors without specific written authorization of Danieli's Management



**NIPPLI DI COLLEGAMENTO E TERMINALI  
PER TUBI FLESSIBILI FILETTATI ISO - NPTF - UN/UNF**  
**HOSE CONNECTING AND END NIPPLES  
THREADED ISO - NPTF - UN/UNF**

**STANDARD N° 2.600.005**

REV. 04	PAGINA PAGE 3	DI OF 8
SOSTITUISCE REPLACES		

**NIPPLO TERMINALE PER TUBI FLESSIBILI FILETTATO ISO 7/1-ISO 228/1**  
**FLEX HOSE END NIPPLE THREADED ISO 7/1-ISO 228/1**

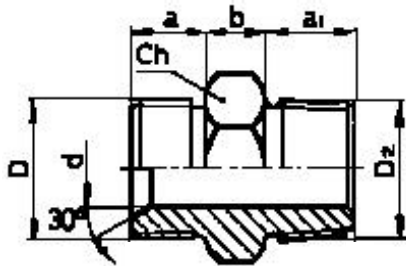

Materiale: acciaio al Carbonio  
Filettature: ISO 7/1  
ISO 228/1-G cl. A  
Rugosità smusso 30°: Ra 2,5 µm  
Finitura: zincato  
Certificazione: EN 10204/2.2

Material: Carbon steel  
Threads: ISO 7/1  
ISO 228/1-G cl. A  
Roughness ch. 30°: Ra 2,5 µm  
Finishing: zinc coated  
Test report: EN 10204/2.2

Es. di design.:  
0.007075.B Nipplo term.flex  
1.1/2"ISO7/1-228/1  
sm30° acc. al C zinc.  
EN 10204/2.2

Ex. of design.:  
0.007075.B Flex end nipple  
1.1/2"ISO7/1-228/1  
ch.30° C steel zinc coat.  
EN 10204/2.2

Dimensioni in mm  
Dimensions in mm

Gestione scorta Magazzino  
Held in stock

DN mm	D ISO 228/1	D <sub>2</sub> ISO7/1	a	a <sub>1</sub>	b	Ch	d	Mass Kg	CODICE CODE
8	1/4	1/4	11	15	6	17	6	0,03	0.007069.L •
10	3/8	3/8	13	15,5	7	22	8,5	0,08	0.007070.H •
15	1/2	1/2	14	20	8	24	11,5	0,08	0.007071.E •
20	3/4	3/4	15,5	20	8	30	17,5	0,1	0.007072.F •
25	1	1	17	25	8	36	23,5	0,2	0.007073.G •
32	1.1/4	1.1/4	18	25,5	10	46	30	0,3	0.007074.A •
40	1.1/2	1.1/2	21	26	10	55	37	0,4	0.007075.B •
50	2	2	22	27	12	65	48	0,55	0.007076.C •

**NIPPLO TERMINALE RIDOTTO PER TUBI FLESSIBILI FILETTATO ISO 7/1-ISO 228/1**  
**FLEX HOSE REDUCER END NIPPLE THREADED ISO 7/1-ISO 228/1**

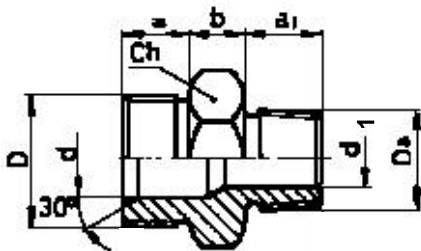

Materiale: acciaio al Carbonio  
Filettature: ISO 7/1  
ISO 228/1-G cl. A  
Rugosità smusso 30°: Ra 2,5 µm  
Finitura: zincato  
Certificazione: EN 10204/2.2

Material: Carbon steel  
Threads: ISO 7/1  
ISO 228/1-G cl. A  
Roughness ch. 30°: Ra 2,5 µm  
Finishing: zinc coated  
Test report: EN 10204/2.2

Es. di design.:  
0.010725.G Nipplo rid.term.flex  
1"ISO228/1x3/4"ISO7/1  
sm30° acc. al C zinc.  
EN 10204/2.2

Ex. of design.:  
0.010725.G Flex red.end nipple  
1"ISO228/1x3/4"ISO7/1  
ch.30° C steel zinc coat.  
EN 10204/2.2

Dimensioni in mm  
Dimensions in mm

Gestione scorta Magazzino  
Held in stock

DN mm	D ISO 228/1	D <sub>3</sub> ISO7/1	a	a <sub>1</sub>	b	Ch	d	d <sub>1</sub>	Mass Kg	CODICE CODE
8 x 6	1/4	1/8	11	15	6	17	6	3,5	0,03	0.010721.C •
10 x 8	3/8	1/4	13	15,5	7	22	8,5	6	0,08	0.010722.D •
15 x 10	1/2	3/8	14	20	8	24	11,5	8,5	0,08	0.010723.E •
20 x 15	3/4	1/2	15,5	20	8	30	17,5	11,5	0,1	0.010724.F •
25 x 20	1	3/4	17	25	8	36	23,5	17,5	0,2	0.010725.G •
32 x 25	1.1/4	1	18	25,5	10	46	30	23,5	0,3	0.010726.A •
40 x 32	1.1/2	1.1/4	21	26	10	55	37	30	0,4	0.010727.B •
50 x 40	2	1.1/2	22	27	12	65	48	37	0,55	0.010728.K •

03	10/97	Revised	Description - Description
04	12/97	Ins. DN	
Rev.	Date		